

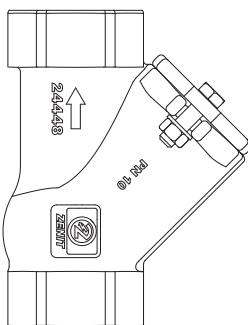

water solutions

## VAP Ø GAS 1¼" - 1½" - 2"



IT	Manuale d'uso e installazione
EN	Use and installation manual
FR	Notice d'entretien
DE	Gebrauchs- und Installationshandbuch
ES	Manual de uso e instalación
PT	Manual de uso e instalação
RU	Инструкции по эксплуатации и монтажу
CN	安装使用指南





## Descrizione della valvola

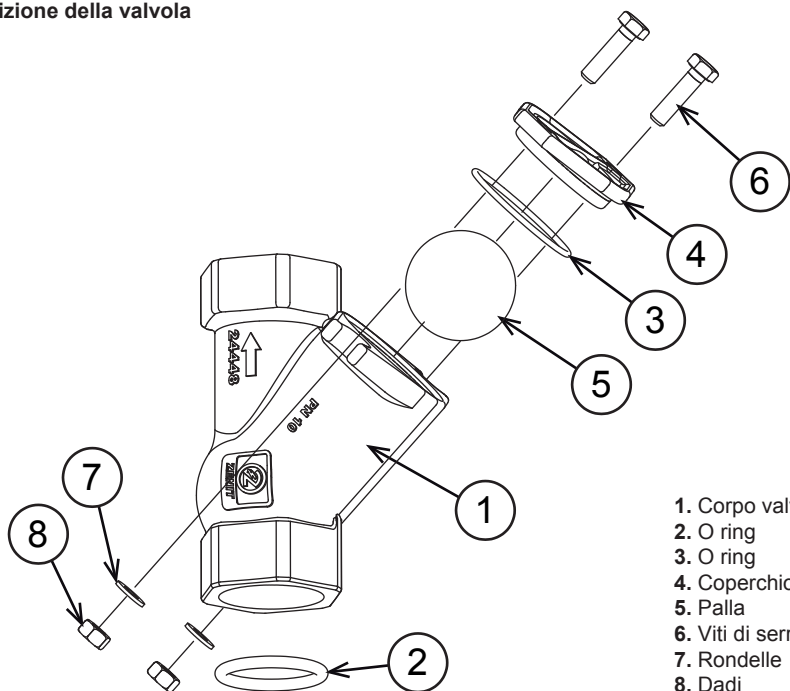

1. Corpo valvola
2. O ring
3. O ring
4. Coperchio
5. Palla
6. Viti di serraggio
7. Rondelle
8. Dadi

## Dimensioni di ingombro

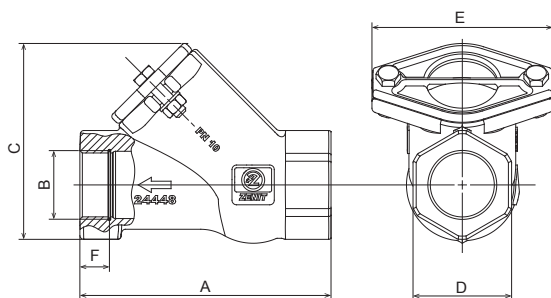

	G32 (11/4")	G40 (11/2")	G50 (2")
<b>A</b> (mm)	153	153	182
<b>B</b> (")	1 1/4"	1 1/2"	2"
<b>C</b> (mm)	119	119	148
<b>D</b> (mm)	60	60	72
<b>E</b> (mm)	110	110	116.5
<b>F</b> (mm)	18	21.5	23
<b>Kg</b>	2.0	1.9	3.0

## Indicazioni per una corretta installazione

### 1. **Installazione VERTICALE**

Nel montaggio verticale occorre prestare attenzione affinché la mandata dell'impianto sia nella direzione indicata della freccia riportata sul corpo valvola.

La valvola a palla "VAP" può essere montata senza nessun vincolo angolare.

Pertanto, è possibile scegliere la posizione della valvola più idonea ruotandola attorno al proprio asse prima di serrarla sulla tubazione, senza comprometterne il funzionamento.

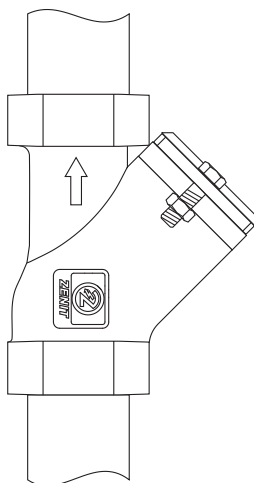

### 2. **Installazione ORIZZONTALE**

La VAP deve essere necessariamente montata con la sede sfera orientata verso l'alto (come nell'immagine) pena il non funzionamento della stessa.

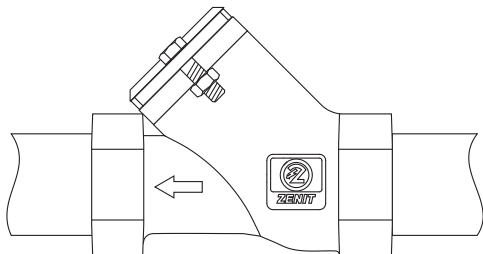

### 3. Installazione con dispositivo di accoppiamento da fondo (DAC)

ATTENZIONE, nel caso di montaggio con dispositivo di accoppiamento da fondo (DAC), montare il lato coperchio della valvola a palla in posizione OPPOSTA ai tubi di scorrimento della flangia di accoppiamento.

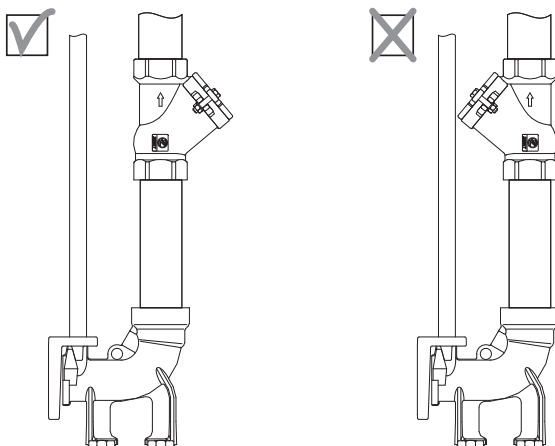

La lunghezza minima consigliata del tratto di tubazione tra valvola a palla (VAP) e mandata del dispositivo di accoppiamento da fondo (DAC),

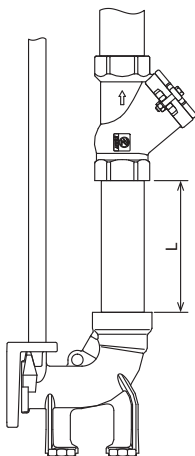

si ricava dalla seguente formula:

$$L \text{ min consigliata} \geq 5 \times \varnothing_i$$

L = Lunghezza tratto di tubazione interposta tra DAC e VAP

$\varnothing_i$  = Diametro interno della tubazione

## Valve description

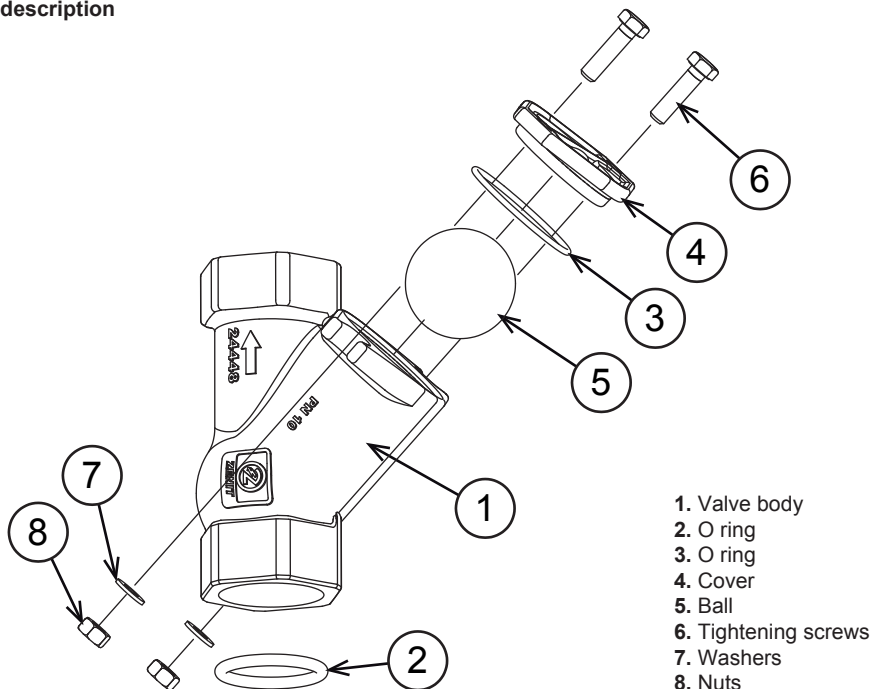

1. Valve body
2. O ring
3. O ring
4. Cover
5. Ball
6. Tightening screws
7. Washers
8. Nuts

## Overall dimensions

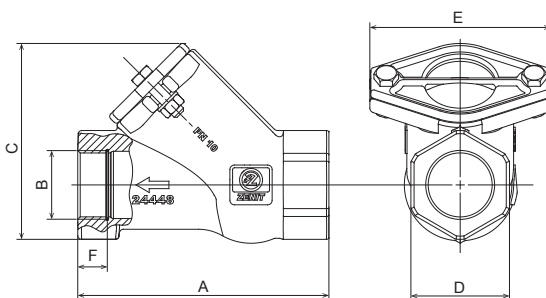

	G32 (11/4")	G40 (11/2")	G50 (2")
<b>A</b> (mm)	153	153	182
<b>B</b> (mm)	1 1/4"	1 1/2"	2"
<b>C</b> (mm)	119	119	148
<b>D</b> (mm)	60	60	72
<b>E</b> (mm)	110	110	116.5
<b>F</b> (mm)	18	21.5	23
<b>Kg</b>	2.0	1.9	3.0

## Instructions for proper installation

### 1. VERTICAL installation

In vertical installation make sure that the delivery to the system is in the direction indicated by the arrow on the valve body.

The VAP ball valve can be fitted without any angular restrictions.

Therefore, you can choose the most suitable position for the valve by turning it around its own axis before tightening it on the pipe without compromising functioning in any way.

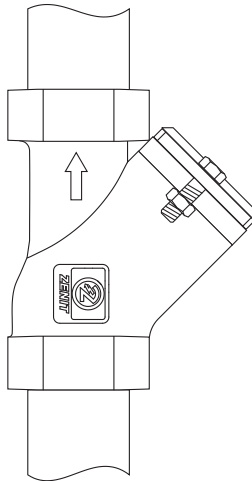

### 2. HORIZONTAL installation

The VAP ball valve must necessarily be fitted with the ball seat turned upwards (as shown in the image), otherwise it will not function.

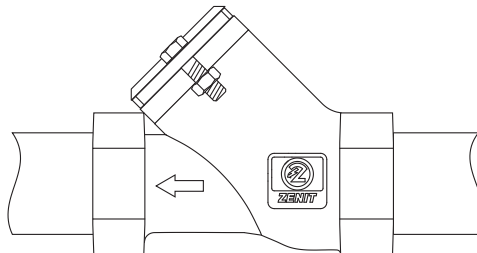

### 3. Installation with bottom coupling device (DAC)

CAUTION: if installing with the bottom coupling device (DAC), fit the cover side of the ball valve in the OPPOSITE position to the coupling flange sliding pipes.

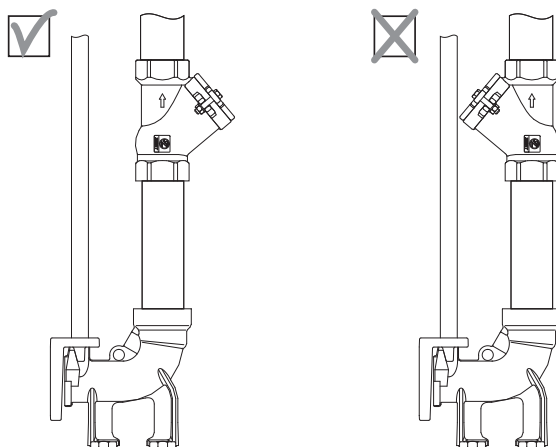

The minimum recommended length for the section of pipe between the ball valve (VAP) and the bottom coupling device (DAC) delivery

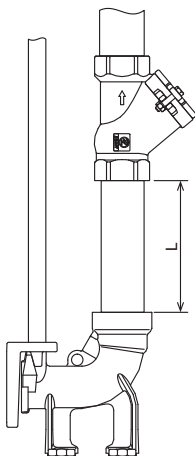

is obtained from the following formula:

$$L \text{ minimum recommended } \geq 5 \times \varnothing_i$$

L = Lunghezza tratto di tubazione interposta tra DAC e VAP

$\varnothing_i$  = Diametro interno della tubazione



### Description de la vanne

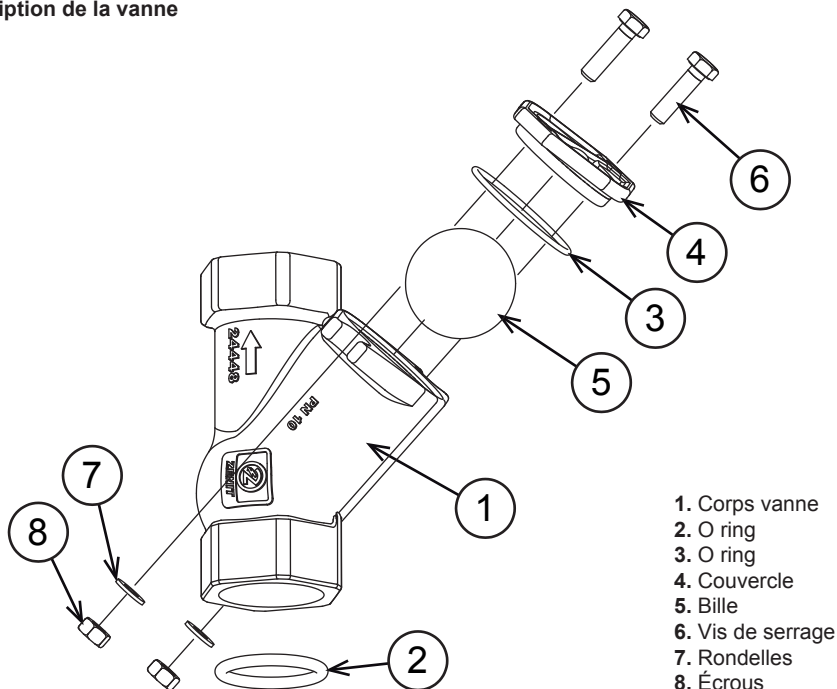

- 1. Corps vanne
- 2. O ring
- 3. O ring
- 4. Couvercle
- 5. Bille
- 6. Vis de serrage
- 7. Rondelles
- 8. Écrous

FR

### Dimensions d'encombrement

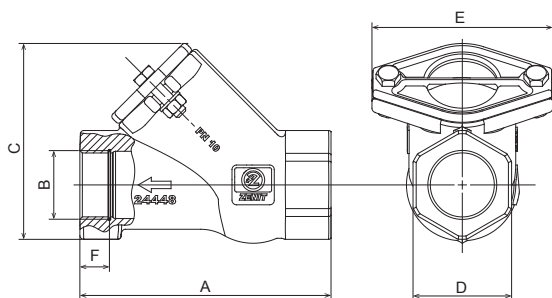

	G32 (1 1/4")	G40 (1 1/2")	G50 (2")
<b>A</b> (mm)	153	153	182
<b>B</b> (mm)	1 1/4"	1 1/2"	2"
<b>C</b> (mm)	119	119	148
<b>D</b> (mm)	60	60	72
<b>E</b> (mm)	110	110	116.5
<b>F</b> (mm)	18	21.5	23
<b>Kg</b>	2.0	1.9	3.0

## Indications pour la correcte installation

### 1. Installation VERTICALE

Dans le montage vertical il faut veiller à ce que le côté de refoulement du système soit tourné dans le sens montré par la flèche gravée sur le corps de la vanne.

Le clapet à bille "VAP" peut être monté sans aucune contrainte angulaire.

Il est donc possible de choisir la position de la vanne plus indiquée en la tournant autour de son axe avant de la fixer sur la tuyauterie, sans compromettre le fonctionnement.

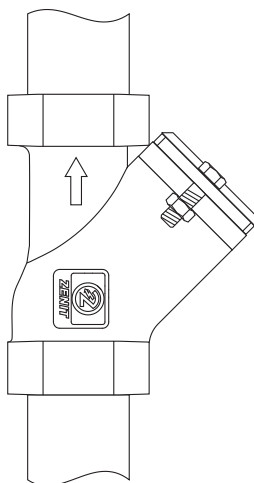

### 2. Installation HORIZONTALE

Le clapet VAP doit être obligatoirement monté avec le logement de la bille orienté vers le haut (comme dans la figure) ; dans le cas contraire, le clapet ne fonctionnerait pas.

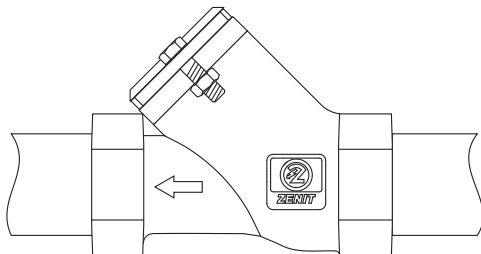

### 3. Installation avec dispositif d'accouplement de fond (DAC)

ATTENTION : en cas de montage avec le dispositif d'accouplement de fond (DAC), monter le côté couvercle du clapet à bille dans la position CONTRAIRE des tuyaux de coulissement de la bride d'accouplement.

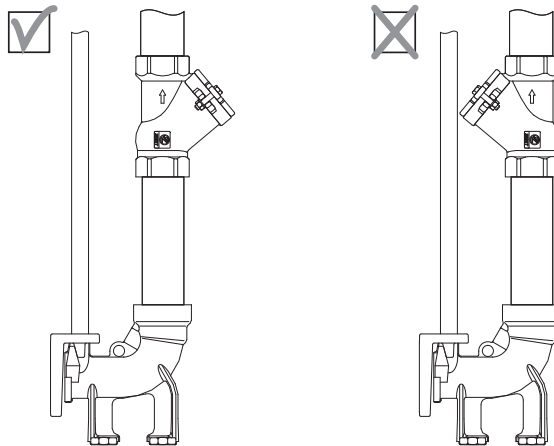

FR

La longueur minimum conseillée pour le morceau de tuyau entre le clapet à bille (VAP) et le refoulement du dispositif d'accouplement de fond (DAC)

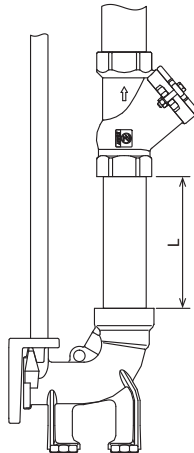

peut être obtenue par la formule suivante :

$$L \text{ longueur mini conseillée } \geq 5 \times \varnothing_i$$

L = La longueur pour le morceau de tuyau intermédiaire entre le DAC et le VAP  
 $\varnothing_i$  = Diamètre intérieur de la tuyauterie

## Beschreibung des Ventils

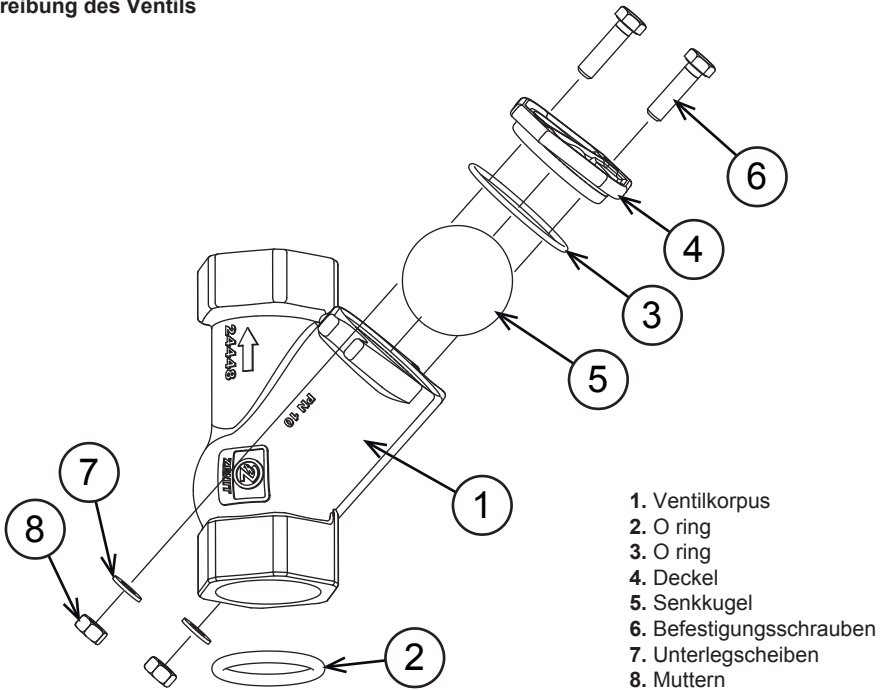

## Abmessungen

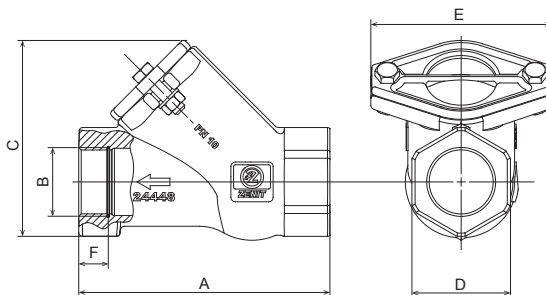

	G32 (11/4")	G40 (11/2")	G50 (2")
<b>A</b> (mm)	153	153	182
<b>B</b> (mm)	1 1/4"	1 1/2"	2"
<b>C</b> (mm)	119	119	148
<b>D</b> (mm)	60	60	72
<b>E</b> (mm)	110	110	116.5
<b>F</b> (mm)	18	21.5	23
<b>Kg</b>	2.0	1.9	3.0

## Hinweise für eine korrekte Installation

### 1. VERTIKALE Installation

Bei der vertikalen Installation ist darauf zu achten, dass die Druckleitung der Anlage in die von dem Pfeil auf dem Ventilkörper angezeigte Richtung führt.

Das Kugelventil "VAP" kann ohne Winkelbeschränkung montiert werden.

Deshalb kann die geeignetste Position des Ventils gewählt werden, indem es um die eigene Achse gedreht wird, bevor es auf der Leitung festgeschraubt wird, ohne dass seine Funktion beeinträchtigt ist.

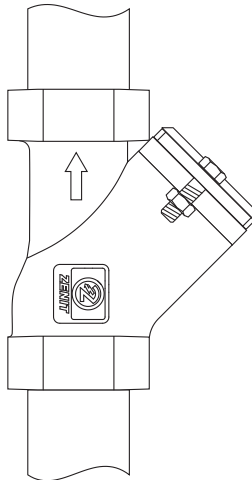

### 2. HORIZONTALE Installation

Das VAP muss notwendigerweise mit dem Kugelsitz nach oben (wie auf der Abbildung) montiert werden, sonst funktioniert es nicht.

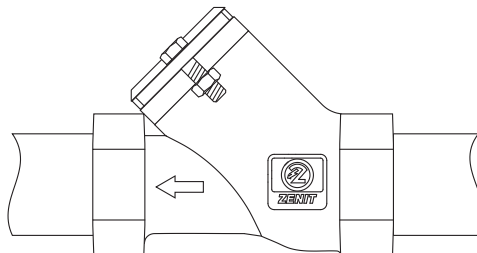

### 3. Installation mit Kupplungsvorrichtung am Boden (DAC)

ACHTUNG: Im Falle der Montage mit der Kupplungsvorrichtung am Boden (DAC) ist die Deckelseite des Kugelventils in der ENTGEGENGESETZTEN Richtung zu den Gleitrohren des Kupplungsflansches zu montieren.

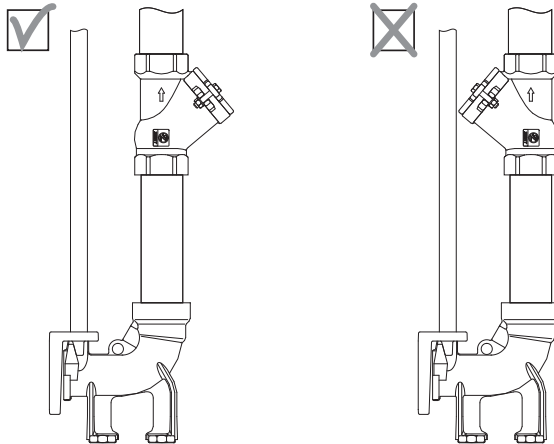

Die empfohlene Mindestlänge des Rohrabschnitts zwischen Kugelventil (VAP) und der Druckleitung der Kupplungsvorrichtung am Boden (DAC)

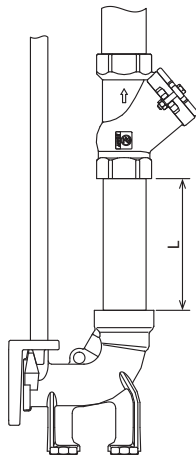

si ricava dalla seguente formula:erhält man aus der folgenden Formel:

$$L \text{ empfohlenes Min.} \geq 5 \times \varnothing_i$$

L = Länge Strecke der Pipeline befindet sich zwischen DAC und VAP  
 $\varnothing_i$  = Innendurchmesser Rohr

### Descripción de la válvula

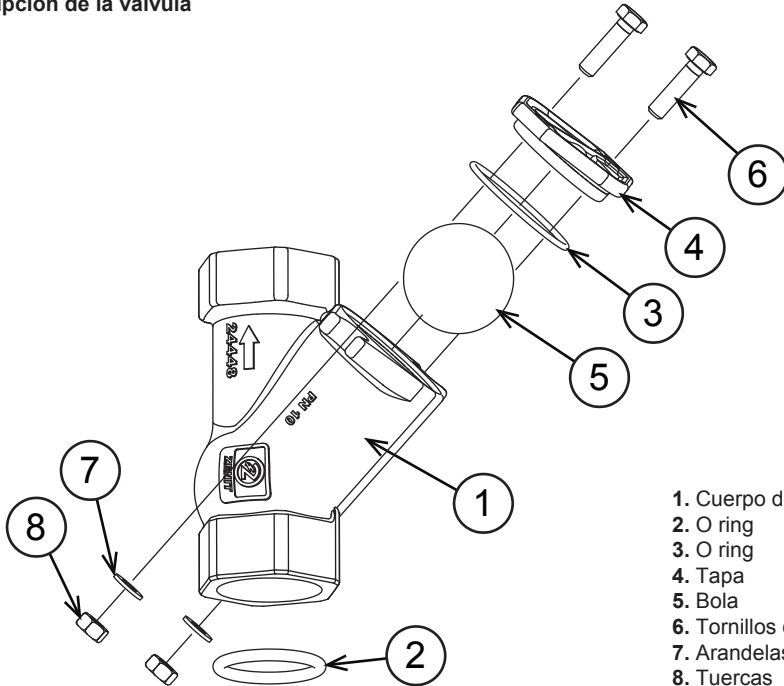

1. Cuerpo de válvula
2. O ring
3. O ring
4. Tapa
5. Bola
6. Tornillos de apriete
7. Arandelas
8. Tuercas

### Dimensiones máximas

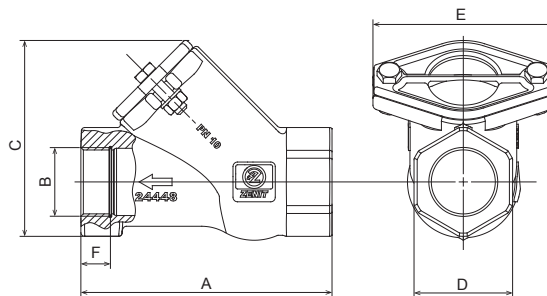

	G32 (1 1/4")	G40 (1 1/2")	G50 (2")
<b>A</b> (mm)	153	153	182
<b>B</b> (mm)	1 1/4"	1 1/2"	2"
<b>C</b> (mm)	119	119	148
<b>D</b> (mm)	60	60	72
<b>E</b> (mm)	110	110	116.5
<b>F</b> (mm)	18	21.5	23
<b>Kg</b>	2.0	1.9	3.0

## Indicaciones para una instalación correcta

### 1. Instalación VERTICAL

En el montaje vertical es necesario prestar atención para que la alimentación de la instalación esté en la dirección indicada por la flecha que aparece en el cuerpo de la válvula.

La válvula de bola "VAP" puede montarse sin ninguna unión angular.

Por lo tanto, se puede elegir la posición de la válvula más adecuada girándola alrededor de su eje antes de apretarla al tubo, sin que esto afecte a su funcionamiento.

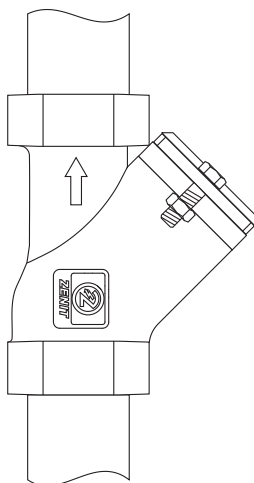

ES

### 2. Instalación HORIZONTAL

La VAP debe montarse obligatoriamente con el alojamiento de la esfera orientado hacia arriba (como se muestra en la imagen), ya que de lo contrario no funcionaría.

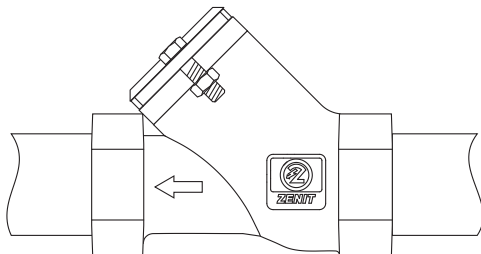



### 3. Instalación con dispositivo de acoplamiento de fondo (DAC)

ATENCIÓN, en caso de montaje con dispositivo de acoplamiento de fondo (DAC), monte el lado de la válvula de bola en posición OPUESTA a las tuberías de deslizamiento de la brida de acoplamiento.

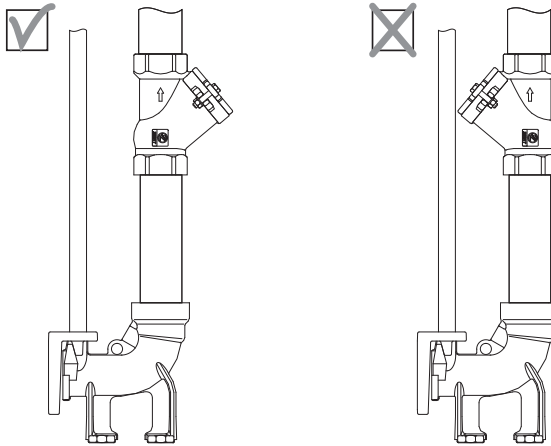

La longitud mínima recomendada del tramo de tubería entre la válvula de bola (VAP) y la alimentación del dispositivo de acoplamiento de fondo (DAC),

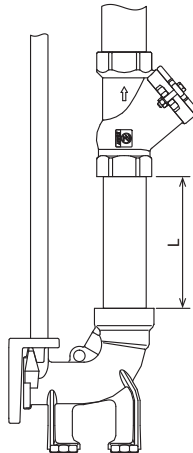

so obtiene de la siguiente fórmula:

$$L \text{ mín. recomendada} \geq 5 \times \varnothing_i$$

L = La longitud del tramo de tubería entre la DAC y la VAP  
 $\varnothing_i$  = Diámetro interno de la tubería

## Descrição da válvula

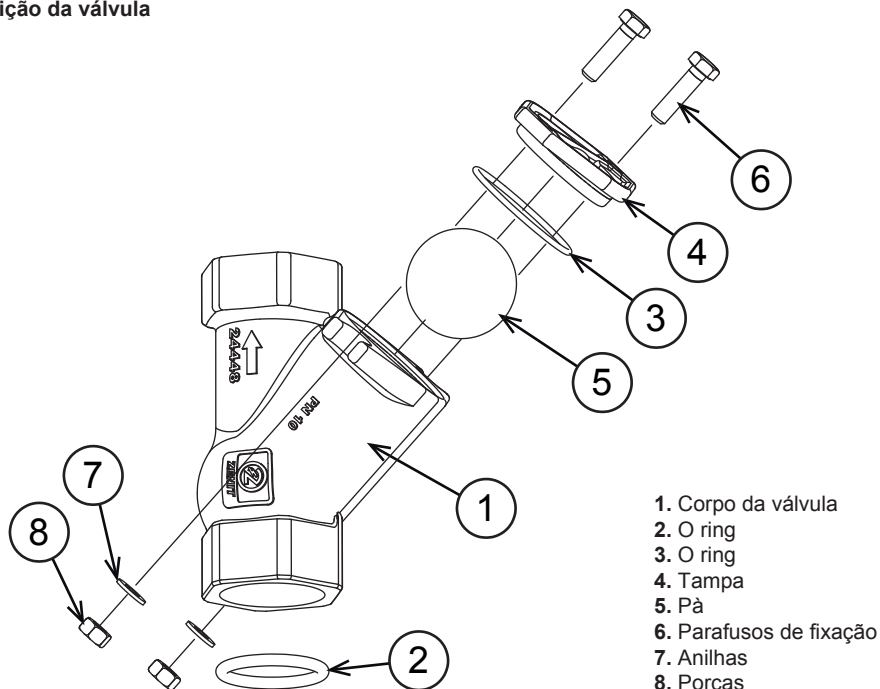

## Dimensões de ocupação

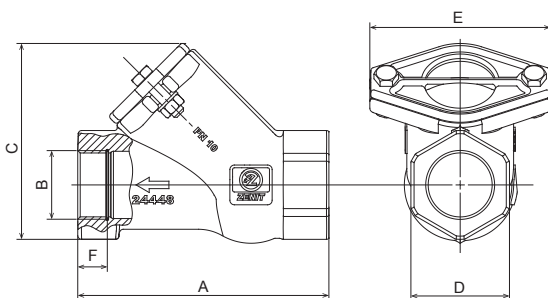

	G32 (11/4")	G40 (11/2")	G50 (2")
<b>A</b> (mm)	153	153	182
<b>B</b> (mm)	1 1/4"	1 1/2"	2"
<b>C</b> (mm)	119	119	148
<b>D</b> (mm)	60	60	72
<b>E</b> (mm)	110	110	116.5
<b>F</b> (mm)	18	21.5	23
<b>Kg</b>	2.0	1.9	3.0

## Indicações para a instalação correcta

### 1. Instalação VERTICAL

Durante a montagem vertical, é preciso prestar atenção para que o envio do sistema esteja na direcção da seta indicada no corpo da válvula.

A válvula a pá "VAP" pode ser montada sem nenhum vínculo angular.

Portanto, é possível escolher a posição da válvula mais adequada a girá-la entornho ao próprio eixo, antes de prendê-la na tubulação sem prejudicar seu funcionamento.

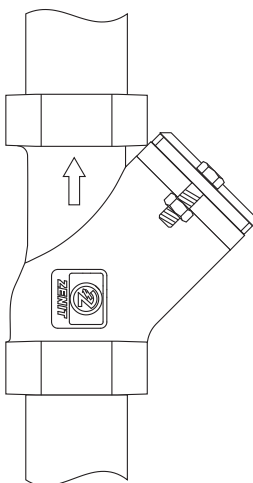

### 2. Instalação HORIZONTAL

A VAP deve ser montada necessariamente com a sede esfera virada para cima (como na imagem), de outro modo, poderia não funcionar.

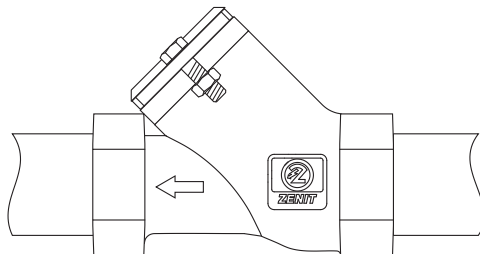

### 3. Instalação com dispositivo de acoplamento de fundo (DAC)

ATENÇÃO, em caso de montagem com dispositivo de acoplamento de fundo (DAC), monte o lado da tampa da válvula a pá, na posição CONTRÁRIA em relação aos tubos de deslizamento do flange de acoplamento.

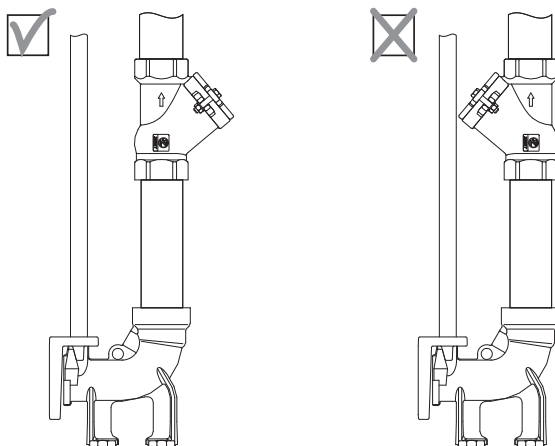

O comprimento mínimo recomendado do trecho de tubulação entre válvula a pá (VAP) e envio de dispositivo de acoplamento de fundo (DAC),

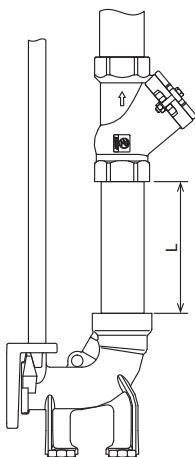

é obtido pela seguinte fórmula:

$$L \text{ mín recomendado} \geq 5 \times \varnothing i$$

L = O comprimento do trecho de tubulação entre DAC e VAP

$\varnothing i$  = Diâmetro interno da tubagem



### Описание клапана

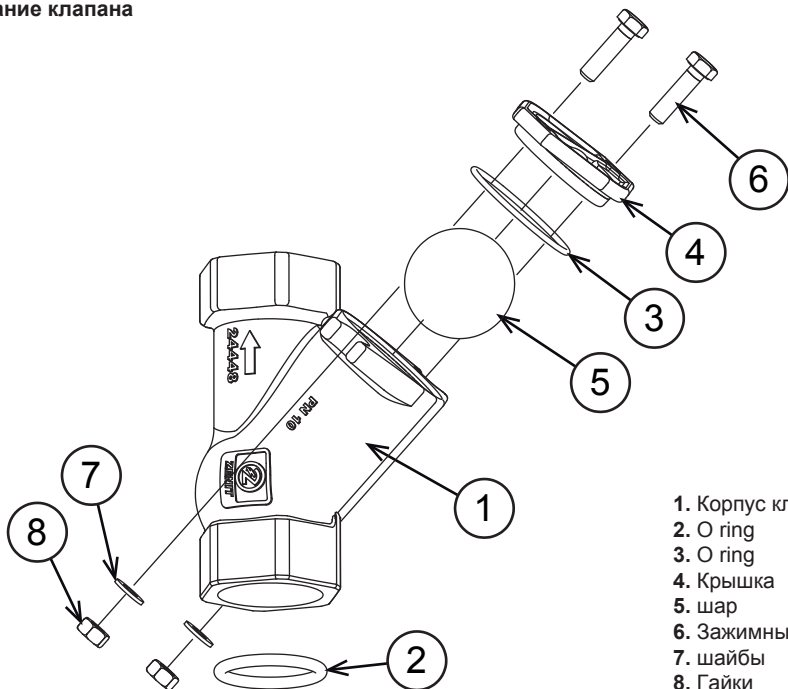

- 1. Корпус клапана
- 2. O ring
- 3. O ring
- 4. Крышка
- 5. шар
- 6. Зажимные винты
- 7. шайбы
- 8. Гайки

### Габаритные размеры

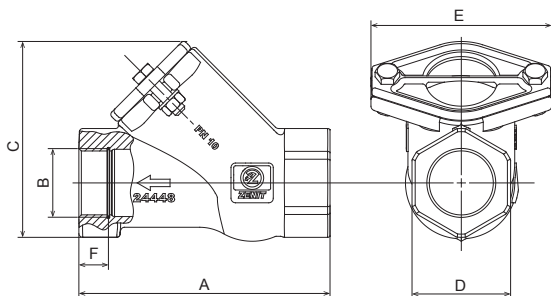

	G32 (1 1/4")	G40 (1 1/2")	G50 (2")
<b>A</b> (mm)	153	153	182
<b>B</b> (mm)	1 1/4"	1 1/2"	2"
<b>C</b> (mm)	119	119	148
<b>D</b> (mm)	60	60	72
<b>E</b> (mm)	110	110	116.5
<b>F</b> (mm)	18	21.5	23
<b>Kg</b>	2.0	1.9	3.0

RU

## Указания для правильной установки

### 1. ВЕРТИКАЛЬНАЯ установка

При вертикальном монтаже необходимо следить за тем, чтобы нагнетание установки соответствовало направлению, показанному стрелкой на корпусе клапана.

Шаровой клапан "VAP" может устанавливаться без каких-либо ограничений по углу.

Поэтому можно выбрать оптимальное положение клапана, поворачивая его вокруг своей оси до крепления на трубопроводе, не нарушая его работоспособности.

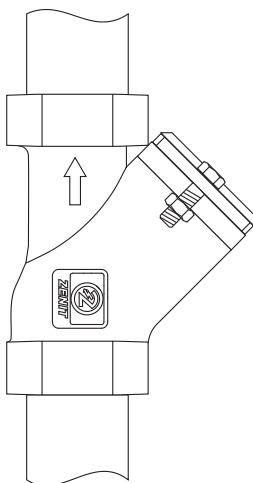

### 2. ГОРИЗОНТАЛЬНАЯ установка

VAP должен обязательно устанавливаться с гнездом шара, обращенным вверх (как показано на рисунке), в противном случае клапан не будет работать.

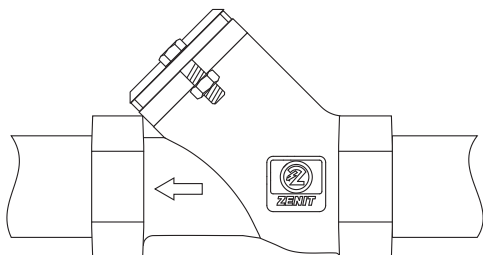

### 3. Установка с донным устройством сопряжения (DAC)

ВНИМАНИЕ, при монтаже с донным устройством сопряжения (DAC) установите сторону крышки шарового клапана в положение, ПРОТИВОПОЛОЖНОЕ трубам перемещения соединительного фланца.

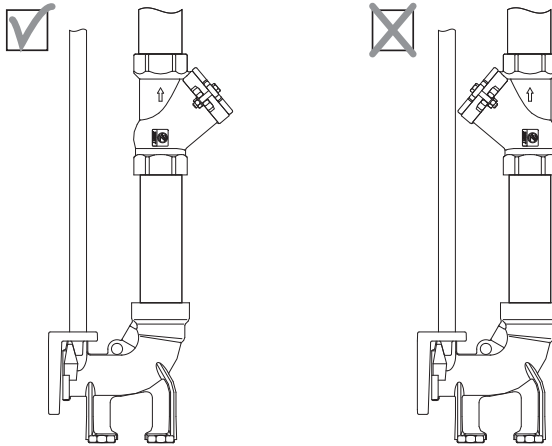

Минимальная рекомендуемая длина участка трубопровода между шаровым клапаном (VAP) и нагнетанием донного устройства сопряжения (DAC)

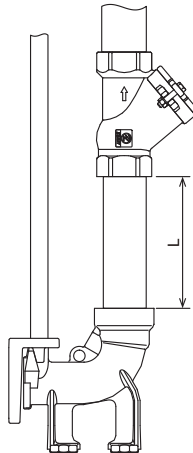

вычисляется по следующей формуле:

$$L \text{ мин. рекомендуемая} \geq 5 \times \varnothing_i$$

L = Длинный участок трубопровода, расположенных между DAC и VAP  
 $\varnothing_i$  = Внутренний диаметр трубопровода

## 零部件描述

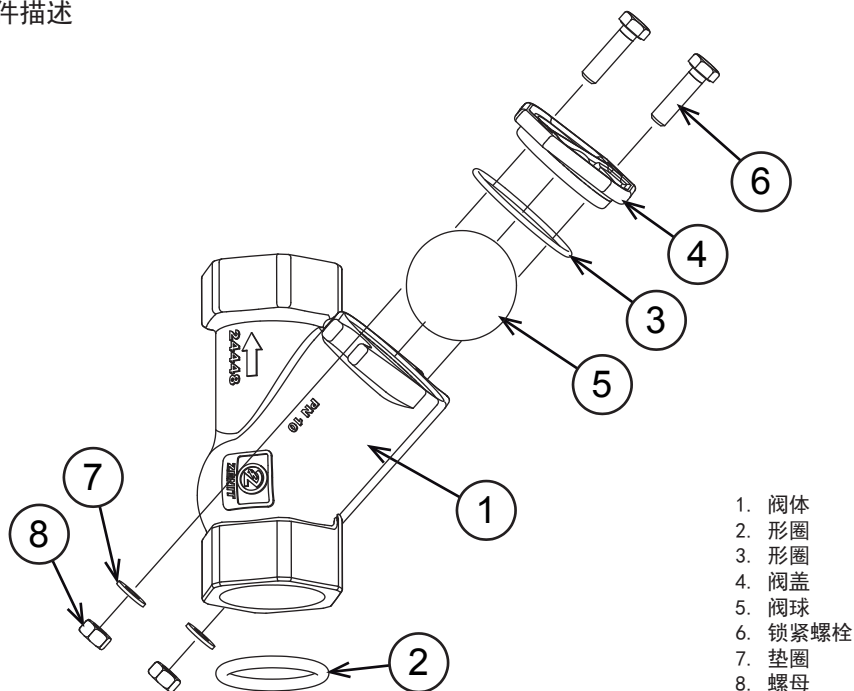

1. 阀体
2. 形圈
3. 形圈
4. 阀盖
5. 阀球
6. 锁紧螺栓
7. 垫圈
8. 螺母

## 外形尺寸

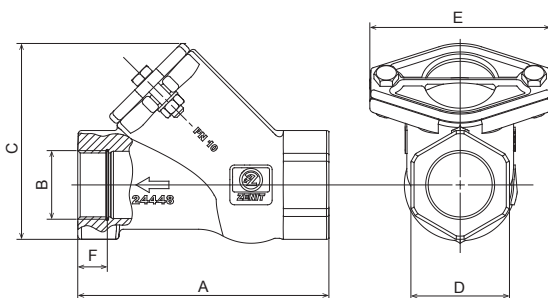

	G32 (11/4")	G40 (11/2")	G50 (2")
<b>A</b> (mm)	153	153	182
<b>B</b> (mm)	1 1/4"	1 1/2"	2"
<b>C</b> (mm)	119	119	148
<b>D</b> (mm)	60	60	72
<b>E</b> (mm)	110	110	116.5
<b>F</b> (mm)	18	21.5	23
<b>Kg</b>	2.0	1.9	3.0



## 正确安装指导

### 1. 垂直安装

垂直安装时确保出口方向按阀体上箭头显示的方向安装。  
VAP 球止回阀没有任何角度位置约束其安装。  
因此在保证阀在管道上旋紧的状态下可以旋转至最合适的位置。

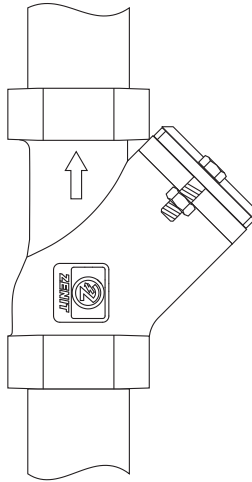

### 2. 水平安装

VAP 球止回阀必须保证阀球座在朝上的位置安装（如图所示），否则达不到效果。

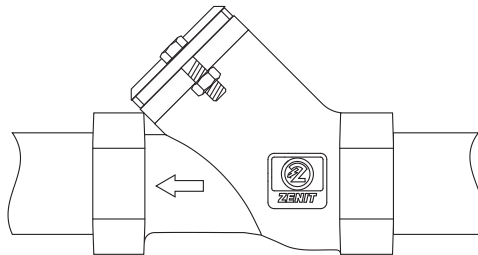

### 3. 带耦合底座 (DAC) 安装

注意：如果带耦合底座 (DAC) 安装，让球止回阀的阀盖朝导杆相反的方向。

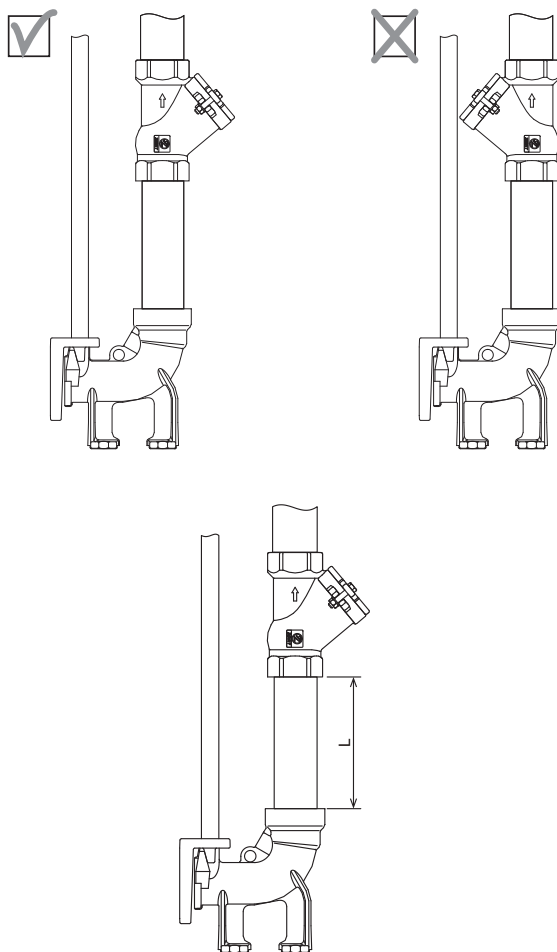

球止回阀 (VAP) 和耦合底座 (DAC) 出口之间的管路最小推荐长度按以下公式：

$$L \text{ 推荐最小长度} \geq 5 \times \varnothing_i$$

L = DAC和VAP之间管的长度

$\varnothing_i$  = 管内径





water solutions

[zenit.com](http://zenit.com)

27270100654100001  
Rev 1 – 01/12/2016